

# 2<sup>ND</sup> ITALIAN CONFERENCE ON THORACIC ONCOLOGY



ROME, June 24<sup>th</sup> - 26<sup>th</sup> 2010

AUDITORIUM PARCO DELLA MUSICA  
PETRASSI ROOM

PROGRAMME

 **AIOT**  
ASSOCIAZIONE ITALIANA ONCOLOGIA TORACICA



*Possiamo sperare?*

# LA VITA PONE DOMANDE. NOI CERCHIAMO LE RISPOSTE.

L'innovazione è la nostra risposta alle continue sfide della salute. Lavoriamo ogni giorno per salvare le vite dei pazienti e per aiutare milioni di persone in tutto il mondo. Leader mondiali nelle biotecnologie: diagnostica in vitro, oncologia, trapiantologia, anemia, virologia, nefrologia e reumatologia sono le nostre aree di eccellenza. Focalizziamo il nostro impegno in ricerca e sviluppo sulla scoperta di nuovi farmaci e tecnologie diagnostiche in grado di combattere il cancro, l'AIDS, l'epatite, l'Alzheimer, l'artrite reumatoide ed il diabete. Grazie ai grandi progressi nella ricerca e alla sinergia tra diagnosi e terapia, siamo pionieri nello sviluppo di test diagnostici e farmaci personalizzati in base alle caratteristiche genetiche di gruppi di pazienti. Ci sono tante risposte quante sono le persone. Noi continuiamo a cercare soluzioni individuali.



*We Innovate Healthcare*

[www.roche.it](http://www.roche.it)

UNDER THE AUSPICES OF



American Society of Clinical Oncology

*Making a world of difference in cancer care*



Information | Research



Associazione Italiana di Oncologia Medica



## SPONSOR LEVEL

### PLATINUM SPONSOR



### GOLD SPONSOR



Risposte che contano.

### OTHER SPONSOR



# INFORMATION





*È stato più facile di quanto pensassi.  
Grazie.*



*Caro Dottore,  
Quando mi ha detto che avevo un  
tumore, l'idea della chemioterapia  
mi terrorizzava.  
Ma aveva ragione: grazie al suo aiuto,  
è stato più facile di quanto pensassi.*

**sanofi aventis**

La salute, la cosa più importante



**PRESIDENT OF THE CONFERENCE**

**Filippo de Marinis**

**ORGANIZING COMMITTEE**

**Filippo de Marinis  
Cesare Gridelli**

**SCIENTIFIC COMMITTEE**

**Andrea Ardizzoni, Fortunato Ciardiello,  
Francesco Grossi, Gaetano Rocco,  
Lucio Trodella**

Il nostro  
principio  
attivo è  
l'innovazione

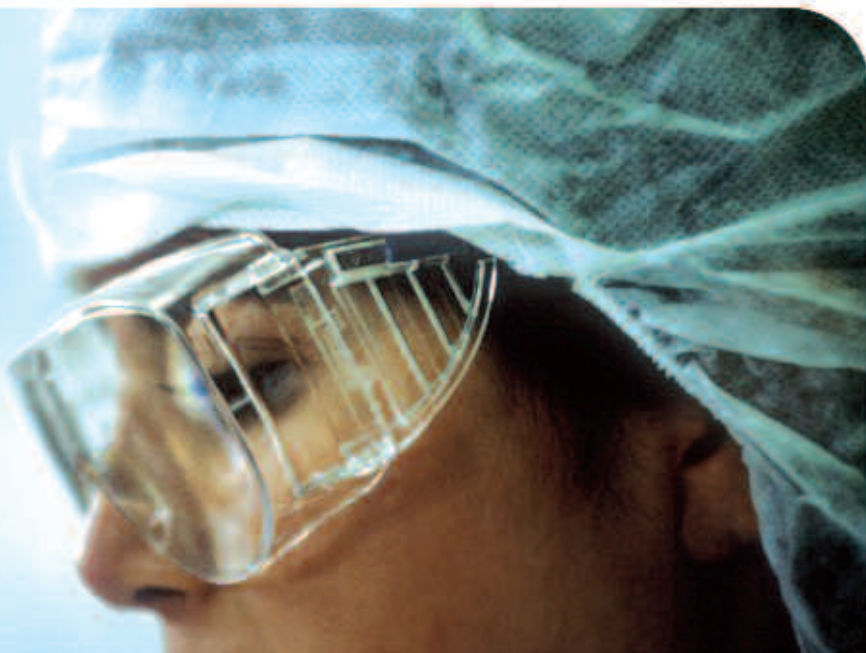

Oncologia  
Neurologia  
Cardiometabolic Care  
Medicina della  
Riproduzione  
Endocrinologia  
Metabolica  
Emergency Care



In Merck Serono lavoriamo quotidianamente per scoprire nuove soluzioni terapeutiche per quelle patologie che non hanno ancora una cura adeguata.

Con un investimento annuo in Ricerca e Sviluppo di circa un miliardo di Euro, un'esperienza consolidata nella chimica farmaceutica e nelle biotecnologie, ed una piattaforma tecnologica all'avanguardia, noi di Merck Serono vogliamo guidare il futuro dell'innovazione terapeutica e dare una risposta adeguata alle esigenze dei pazienti.

## SCIENTIFIC INFORMATION

### MAIN SCIENTIFIC PROGRAMME OUTLINE

The scientific programme covers three days (Thursday June 24, Friday June 25 and Saturday June 26, 2010) and consists of State-of-the-Art Lectures, Main Lectures, Debates and Face to Face sessions.

The “Debates” sessions will be about controversial topics in thoracic oncology; the “Face to Face” sessions instead will go on vexed questions and they will deal with two speakers and to add requests from some “shooters” put in charge in order to stimulate the audience for a lively discussion.

### WEBSITE

Virtual Meeting of the Conference will be available after the end of the Meeting on AIOT official website [www.oncologiatoracica.it](http://www.oncologiatoracica.it).

### ITALIAN MINISTRY OF HEALTH - CME CREDITS AND ESMO MORA POINTS

The accreditation has been asked for entirely meeting. To obtain Italian credits the delegates must attend in the 100% percentage of the time sessions. An electronic device will be arrange.

At the moment of registration each participant receives the evaluation forms and learning questionnaire of the scientific sessions. These forms and questionnaire must be filled in and return to the “CME credits” desk. Electronic tags will be used to record the CME credits. The electronic readers are placed at the beginning of the stairs to access in “Petrassi” room. It is sufficient to pass through the electronic device to have the credits recorded.

To obtain credits, Italian participants must be:

- record both the entrance and the exit of each Meeting day
- return the electronic tag to the Organizing Secretariat at the end of the Conference
- return the evaluation forms and questionnaire duly filled into the “CME credits” desk. The anagraphical data must compulsorily be indicated since required by the Italian Ministry of Health

**Please note that should you loose or fail the tag, you will be charged € 10,00 by the Organizing Secretariat.**

## FACULTY INFORMATION

**A. Ardizzoni** (Parma, I)

**E. Bajetta** (Milan, I)

**C. Belani** (Hershey, PA, USA)

**P. Bass** (Amsterdam, NL)

**F. Cappuzzo** (Rozzano, MI, I)

**F. Ciardiello** (Naples, I)

**L. Crinò** (Perugia, I)

**F. de Marinis** (Rome, I)

**J. Y. Douillard** (Nantes, F)

**E. Felip** (Barcelona, E)

**D. Gandara** (Sacramento, CA, USA)

**S. Gasparini** (Ancona, I)

**V. Gebbia** (Palermo, I)

**C. Gridelli** (Avellino, I)

**F. Grossi** (Genoa, I)

**S. Lastoria** (Naples, I)

**T. Le Chevalier** (Paris, F)

**V. Miller** (New York, NY, USA)

**T. Mok** (Hong Kong, HK)

**F. Mornex** (Lyon, F)

**M. O' Brien** (Sutton, UK)

**K. O' Byrne** (Dublin, IRL)

**R. Pirker** (Vienna, A)

**M. Reck** (Grosshandsorf, D)

**G. Rocco** (Naples, I)

**R. Rosell** (Barcelona, E)

**A. Santoro** (Rozzano, MI, I)

**F. A. Shepherd** (Toronto, CAN)

**J. C. Soria** (Paris, F)

**L. Spaggiari** (Milan, I)

**R. Stahel** (Zurich, CH)

**K. Syrigos** (Athens, GR)

**N. Thatcher** (Manchester, UK)

**L. Trodella** (Rome, I)

**D. Zips** (Dresden, D)



## **FACULTY**

### **Guidelines for Speakers and Chairs**

#### **For Chairs:**

- Locate your session Room in due time
- Be in the Room assigned for presentation at least 10 minutes before the beginning of the session
- Respect the timing allowed to the session and each presentation
- All presentations, discussions and questions are in English

#### **For Speakers:**

- Follow the instruction indicated at the paragraph “Audiovisual Instruction”
- Locate your session Room in due time
- Be in the Room assigned for presentation at least 10 minutes before the beginning of the session to meet the Chairs
- Respect the timing allowed for your presentation
- All presentations, discussions and questions are in English

## **AUDIOVISUAL INSTRUCTION**

A multimedial projection centre is at the disposal of the Speakers at the ground floor of the Parco della Musica.

### **ONLY PC DATA PROJECTION WILL BE AVAILABLE AT THE CONFERENCE**

The “Petrassi” room is provided with the laptop.

**Use of one’s laptop is not allowed.**

Should Speakers have their personal laptop, a CD Rom or a USB key, they are kindly requested to go to the multimedial projection centre to have their presentation copied. The presentation will be then forwarded through a LAN network from multimedial projection centre directly to the computer in the presentation room.

We recommend to contact the multimedial projection centre the day before your presentation. At any rate, presentation material must be available:

- **45 minutes** before for Power Point presentation on CD Rom or USB key
- **1 hour** before for presentation on Personal Computer

## **CERTIFICATE OF ATTENDANCE**

Attendance certificates will be issued on request to all regularly registered participants at the Secretariat Desk at the end of the meeting.

## GENERAL INFORMATION

### CONFERENCE VENUE



**Petrassi room**  
**Auditorium Parco della Musica**  
Viale P. de Coubertin 10, Roma  
Tel. 06802411

Auditorium Parco della Musica was been planned by architect Renzo Piano and as all his projects is characterized by peculiar architectural aspects. The used building materials help to do unique this venue: transparent surfaces, the lead, the travertine stones, wood and red small bricks.

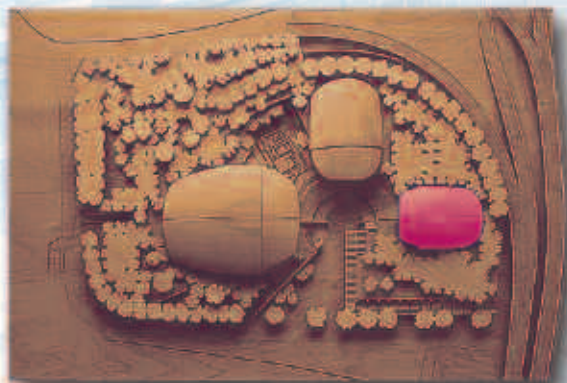
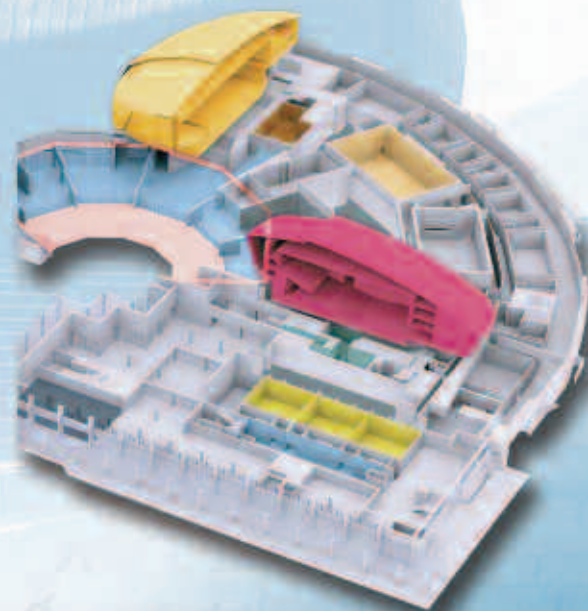

## PARKING FACILITIES

The open air car parking, located aside the Auditorium, is at disposal of all the delegates free of charge; the indoor's one is at disposal of the participants at their charge.

## PUBLIC TRANSPORT



### Autobus

**910** - from Termini Station and P.zza Mancini

**53** - from P.zza Mancini  
and P.zza San Silvestro

**217** - from V.le XVII Olimpiade  
and Termini Station

**231** - from P.zza Mancini

**Linea "M"** - special bus track between  
Termini Station and Auditorium bus stop  
at V.le Pietro de Coubertin  
(from h. 07.00, every 15 minutes).



### Tram

**2** - from P.le Flaminio and P.zza

Mancini



### Underground

**A Line** - P.le Flaminio underground  
stop and  
tram 2 Railway Rome North,  
P.zza Euclide tram stop

## SECRETARIAT AND REGISTRATION DESKS

The pre-registration and on site registration desks are at the disposal of participants as follow:

Thursday, **June 24** - 12.00/20.00 hrs

Friday, **June 25** - 08.00/19.00 hrs

Saturday, **June 26** - 08.00/14.00 hrs

At the secretariat desk are available the following services:

- On site registration (cash, cheques)
- Pre-registrations A - L
- Pre-registrations M - Z
- Faculty registration
- Travel agency
- CME credits desk
- AIOT Secretariat
- Information

## CLOAKROOM

It is at disposal of all the guests free of charge. Delegates are kindly requested not to leave their personal belongings after the closing time.

## BAR

Located in the Conference area it is at the disposal of the participants at their charge.

## INSURANCE

Conference organizers cannot accept liability for personal injuries or for loss of or damage to property belonging to congress participants, either during or as a result of the Conference.

## REGISTRATION FEES

### WHAT IS COVERED BY THE FEE?

The registration fee includes unlimited access to all scientific sessions, a full set of congress material and lunch on Friday June 25.

All the information are available on web site [www.oncologiatoracica.it](http://www.oncologiatoracica.it) in the section “how to do a registration”

### ADMISSION

Name badges are used as passes. All participants and official guests are kindly requested to wear their name badge during the Meeting activities and social events. The badge allows the entrance to the scientific sessions and lunch.

## PRACTICAL INFORMATION

### CLIMATE

June weather in Rome is generally sunny and warm. The temperature often rises during the day at an average of 25°. Light summer clothing is most suitable. Rain is also possible; light raincoat and something warm for the evening are advisable

### CURRENCY

The official currency in Italy is the Euro (€).

### TIPPING

Service is usually included in the bill in bars and restaurants but tips are welcome.

### BANK

Banks are open from Monday to Friday from 08.30 to 13.30 hrs and from 15.00 to 16.00 hrs. Banks are closed on Saturday and Sunday. Many banks have automatic currency exchange machines that also take credit cards.

Most hotels, restaurants and shops accept foreign currency and major credit cards.

### ELECTRICITY

Voltage is 220V AC, 50Hz. plugs have two or three round pins. Foreign voltage could require and adapter.

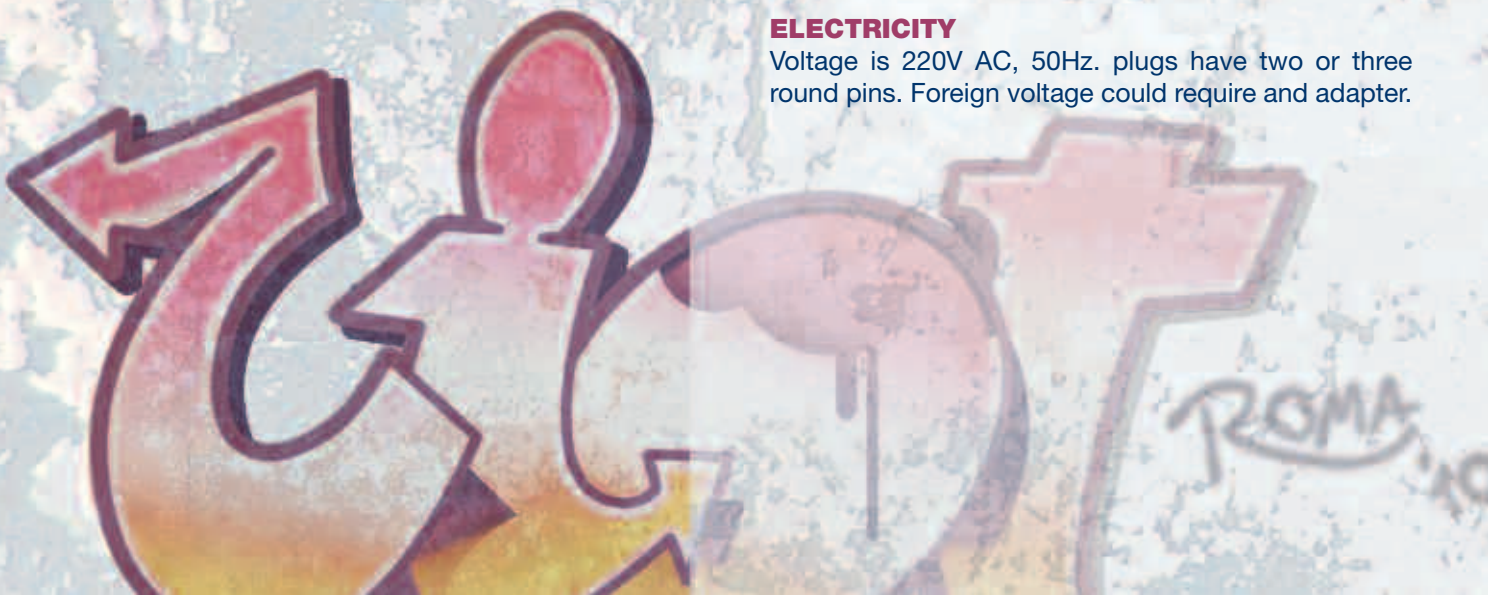



**ROME**



**ATTRACTIONS**

## KEY ATTRACTIONS

1



Imperial Forums

2



Flavian Amphitheater  
*or more known as Colosseum*

3



Piazza Venezia

4



Monument of Vittorio Emanuele II  
*or Altare della Patria*

5



Capitol

6



Piazza di Spagna

7



Castel Sant'Angelo

8



Basilica of St. Paul outside the Walls

9

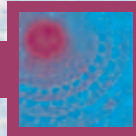

Pantheon

10



Trevi Fountain

11



Sistine Chapel

12



San Peter Basilica



11

7

6

10

12

9

3

4

5

2

1

8

# PROGRAMME



**15.00-17.00 THORACIC MALIGNANCY**

Chairmen:

**A. Santoro** (Milan, I)

**R. Stahel** (Zurich, CH)

**15.05** Trimodality approach in malignant pleural mesothelioma (MPM)  
**R. Stahel** (Zurich, CH)

**15.25** Chemotherapy and targeted therapies for malignant pleural mesothelioma (MPM)  
**P. Baas** (Amsterdam, NL)

**15.45** New insights in the treatment of neuroendocrine tumors (NET)  
**E. Bajetta** (Milan, I)

**16.05** Multimodality treatment of malignant thymoma  
**F. Mornex** (Lyon, F)

**16.25** Beyond platin/etoposide in SCLC  
**M. O'Brien** (Sutton, UK)

**16.45** Discussion

**17.00-18.00 FACE TO FACE**  
Optimal Mediastinal Staging: surgery vs non invasive approaches (EBUS / PET)

Questions from  **L. Spaggiari** (Milan, I)

Answers from  **S. Gasparini** (Ancona, I) and **S. Lastoria** (Naples, I)

**18.00-18.15 WRAP UP OF DAY 1**  
**A. Ardizoni** (Parma, I)

June 25, 2010 Friday Morning

9.00-9.30 **OPENING CEREMONY**

9.30-10.15 **OPENING LECTURE**



Introduction  
**C. Gridelli** (Avellino, I)

9.45 New developments in the treatment of NSCLC  
**D. Gandara** (Sacramento, CA, USA)

10.15-12.30 **RESECTABLE DISEASE**

Chairmen:

**A. Ardizzone** (Parma, IT)

**G. Rocco** (Naples, I)

10.20  Keynote Lecture

Molecular biomarkers and gene signature in early stage NSCLC

**K. O' Byrne** (Dublin, IRL)

10.50 Adjuvant vs Neoadjuvant chemotherapy  
**E. Felip** (Barcelona, ES)

11.10 Is there a role for adjuvant and neoadjuvant radiotherapy?  
**F. Mornex** (Lyon, F)

11.30 Potential role of targeted therapies in the adjuvant setting  
**V. Miller** (New York, NY, USA)

11.50 The role of vaccines  
**N. Thatcher** (Manchester, UK)

12.10 Discussion

12.30-14.00 **LUNCH**

**14.00-15.30**    **LOCALLY ADVANCED  
UNRESECTABLE DISEASE**

Chairmen:

**L. Crinò** (*Perugia, I*)

**L. Trodella** (*Rome, I*)

**14.05**            Chemotherapy and radiotherapy  
combination : is there a standard?  
**F. Grossi** (*Genoa, I*)

**14.25**            The role of PET in predicting and  
assessing response  
**S. Lastoria** (*Naples, I*)

**14.45**            Integration of novel targeted  
therapy to combined  
chemo-radiation  
**D. Zips** (*Dresden, D*)

**15.05**            Discussion

**15.30-18.00**    **1<sup>st</sup>-LINE TREATMENT OF  
ADVANCED DISEASE**

Chairmen:

**C. Gridelli** (*Avellino, I*)

**N. Thatcher** (*Manchester, UK*)

**15.35**            Why old platin-based doublets?  
**J.Y. Douillard** (*Nantes, F*)

**15.55**            Why pemetrexed?  
**D. Gandara** (*Sacramento, CA, USA*)

**16.15**            Why bevacizumab?  
**M. Reck** (*Grosshansdorf, D*)

**16.35**            Why cetuximab?  
**R. Pirker** (*Vienna, A*)

**16.55**            Why gefitinib?  
**T. Mok** (*Hong Kong, HK*)

**17.15**            Why erlotinib?  
**C. Gridelli** (*Avellino, I*)

**17.35**            Discussion

**18.00-18.15**    **WRAP UP OF DAY 2**  
**F. Grossi** (*Genoa, I*)

- 8.30-9.30** **FACE TO FACE**  
Is there a role for maintenance treatment in clinical practice?  
If yes, chemotherapy or targeted therapies?
- Questions from  **T. Le Chevalier** (Paris, F)
- Answers from  **C. Belani** (Hershey, PA, USA) and **F. Cappuzzo** (Rozzano, MI, I)
- 9.30-10.30**  **QUESTIONS ON...**  
Chairman:  
**F. Shepherd** (Toronto, CAN)
- 9.35** Is there a new generation drugs for first-line treatment of advanced NSCLC ?  
**J.C. Soria** (Paris, FR)
- 9.55** Is there a role for pharmacogenomic in clinical practice for advanced NSCLC ?  
**R. Rosell** (Barcelona, ES)
- 10.15** Discussion
- 10.30-12.45** **BEYOND FIRST-LINE TREATMENT OF ADVANCED NSCLC**  
Chairman:  
**F. de Marinis** (Rome, I)
- 10.35** Which chemotherapy?  
**F. de Marinis** (Rome, I)
- 10.55** EGFR TKI  
**F. Shepherd** (Toronto, CAN)
- 11.15** Vandetanib  
**F. Ciardiello** (Naples, I)
- 11.35** Sorafenib and sunitinib  
**V. Gebbia** (Palermo, I)
- 11.55** IGFR- Is and New Targeted Therapies  
**K. Syrigos** (Athens, GR)
- 12.15** Discussion
- 12.45-13.00** **WRAP UP OF DAY 3**  
**C. Gridelli** (Avellino, I)
- 13.00** **CLOSING REMARKS**  
**F. de Marinis** (Rome, I)



**NO SMOKING**

Smoking  
in the  
Meeting area  
**IS NOT**  
allowed

## **MOBILE PHONE**

Delegates  
are **KINDLY**  
requested  
to keep  
their  
mobile phones  
in the  
**OFF POSITION**  
in the Room  
where  
scientific  
sessions  
are being held.





A close-up, low-angle shot of an hourglass. The top bulb is filled with a thick, golden-brown sand. The narrow neck is the focal point, with a small metal cap at the bottom. The bottom bulb is empty, and a stream of sand is captured mid-fall, creating a blurred, golden trail. The background is a soft, warm, golden light, creating a sense of time and value.

**La Ricerca  
GlaxoSmithKline  
in Oncologia.**

**Più tempo alla vita.**



GlaxoSmithKline  
Oncology

# ARRIVEDERCI



# 2012

# life inspiring ideas

In **oncologia** la storia di AstraZeneca è lunga quanto quella dell'oncologia moderna. Già all'inizio degli anni '60 AstraZeneca (allora ICI) scopriva e sviluppava il primo farmaco in grado di contrastare la crescita tumorale. Da allora abbiamo percorso molta strada, sviluppando molecole che ci hanno permesso di diventare leader nel campo della terapia ormonale del tumore mammario e prostatico e una conoscenza che fa di noi un'azienda all'avanguardia nel settore, con farmaci sempre più selettivi, quindi efficaci e tollerabili. Grazie alla nostra conoscenza ed esperienza nel campo dei recettori cellulari e delle formulazioni orali, abbiamo sviluppato il primo farmaco di una nuova classe di antitumorali ad azione farmacologica fortemente innovativa per la terapia del tumore polmonare. La nostra storia continuerà con quella dell'oncologia. Grazie alla condivisione delle conoscenze e alla passione di tutte le nostre persone, la percorreremo accanto ai medici e agli oncologi di tutto il mondo con **obiettivi sempre più ambiziosi**.

Dalle idee creiamo soluzioni.

AstraZeneca   
[www.astrazeneca.it](http://www.astrazeneca.it)

anestesiologia

cardiovascolare

gastroenterologia

malattie infettive

malattie metaboliche

neuroscienze

oncologia

pneumologia





THIS PROGRAMME IS ALSO AVAILABLE ON AIOT WEBSITE  
[www.oncologiatoracica.it](http://www.oncologiatoracica.it)



**PROVIDER ECM**  
AIOT - Associazione Italiana di Oncologia Toracica  
Via Salaria, 237 - 00199 Roma  
Tel. +(39) 333 65 93 541 - Fax (+39) 06 85 40 679  
[oncologiatoracica@yahoo.it](mailto:oncologiatoracica@yahoo.it) - [www.oncologiatoracica.it](http://www.oncologiatoracica.it)



Scientific Organizing Service

**ORGANIZING SECRETARIAT by**  
SOS S.r.l.  
Via Salaria, 237 - 00199 Roma  
Tel. (+39) 333 65 93 541 - Fax (+39) 06 85 40 659  
[rossella.spinetti@alice.it](mailto:rossella.spinetti@alice.it)